



Chilled Water Plant Improvements Project
Solicitation Number: CO-00051
Job No.: 15-7502

ADDENDUM 2
February 9, 2016

To Respondent of Record:

This addendum, applicable to work referenced above, is an amendment to the bid proposal, plans and specifications and as such will be a part of and included in the Contract Documents. Acknowledge receipt of this addendum by entering the Addendum number and issue date on the space provided in submitted copies of the bid proposal.

MODIFICATION TO THE SPECIFICATIONS

A change has been made to the Bid Proposal. Remove and replace Bid Proposal with the attached.

END MODIFICATION TO THE SPECIFICATIONS

QUESTIONS AND ANSWERS

1. **Question: The 8,700 sf Asphalt chip seal shown on the bid proposal is suspect for area defined in the plans. Please confirm quantity.**

Answer: Page BP-2 ALT P-1 Change 8,700 sf to 22,210 Sq.ft. See updated drawing issued with this addendum for area to receive chip seal.

2. **Question: The seal coat rock as defined in proposal is to have Aggregate to be Santa Fe 1/4" to 3/8" Blend. Please provide sources for this material as this is not a standard seal coat rock utilized in typical roadway operations.**

Answer: Keller Materials - Address: 9388 Corporate Dr. Selma, TX 78154 Phone: (210) 967-1300.

3. **Question: As contained in the bid proposal, the specification for the application of the chip seal requires equipment that will exceed the 6000 pound weight limitations for the vault. Please provide direction on what type of equipment will be acceptable.**

Answer: The weight limit will NOT exceed 6000 pounds. SAWS will consider other methods available to the successful contractor, such as hand application of the materials or the utilization of light weight walk behind equipment to accomplish this task within the specified limits at no additional cost to the project.

4. **Question: In reference to the Landscape & Irrigation of the project, is it possible to obtain the following:**

- 1) Landscape Drawings
- 2) Irrigation Drawings

of the neighboring planters that have been completed? This may be needed to see the type of plants and sizes in the event that plants may be damaged during the construction of the new planters.

Answer: The irrigation systems recently installed will be flagged prior to the start of this project. Drawings showing the irrigation piping will be provided to the successful bidder.

END OF QUESTIONS AND ANSWERS

CHANGES TO DRAWINGS

Item No. 1: Sheet L1.0

Replace previously issued sheet, dated January 21, 2016, with attached revised sheet dated **February 8, 2016**

- A. Revised pressure loss calculations
- B. Revised existing irrigation
- C. Added/revised zone sizes

Item No. 2: Sheet L1.1

Replace previously issued sheet, dated January 21, 2016, with attached revised sheet dated **February 8, 2016**

- A. Revised existing irrigation
- B. Revised irrigation notes

Item No. 3: Sheet L1.2

Replace previously issued sheet, dated January 21, 2016, with attached revised sheet dated **February 8, 2016**

- A. Revised existing irrigation
- B. Revised irrigation notes
- C. Added/revised zone sizes

Item No. 4: Sheet L1.3

Replace previously issued sheet, dated January 21, 2016, with attached revised sheet dated **February 8, 2016**

- A. Revised existing irrigation
- B. Revised irrigation notes
- C. Added/revised zone sizes

Item No. 5: Sheet L4.1

Replace previously issued sheet, dated January 21, 2016, with attached revised sheet dated **February 8, 2016**

- A. Revised chip seal area

Item No. 6: Sheet L4.2

Replace previously issued sheet, dated January 21, 2016, with attached revised sheet dated **February 8, 2016**

- A. Deleted decomposed granite between courtyard and building (granite is existing in this area)

NOTE:

Drawin

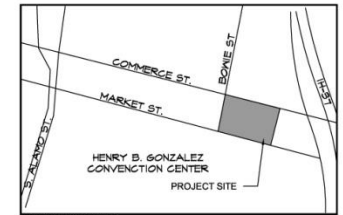

VICINITY MAP
(NOT TO SCALE)

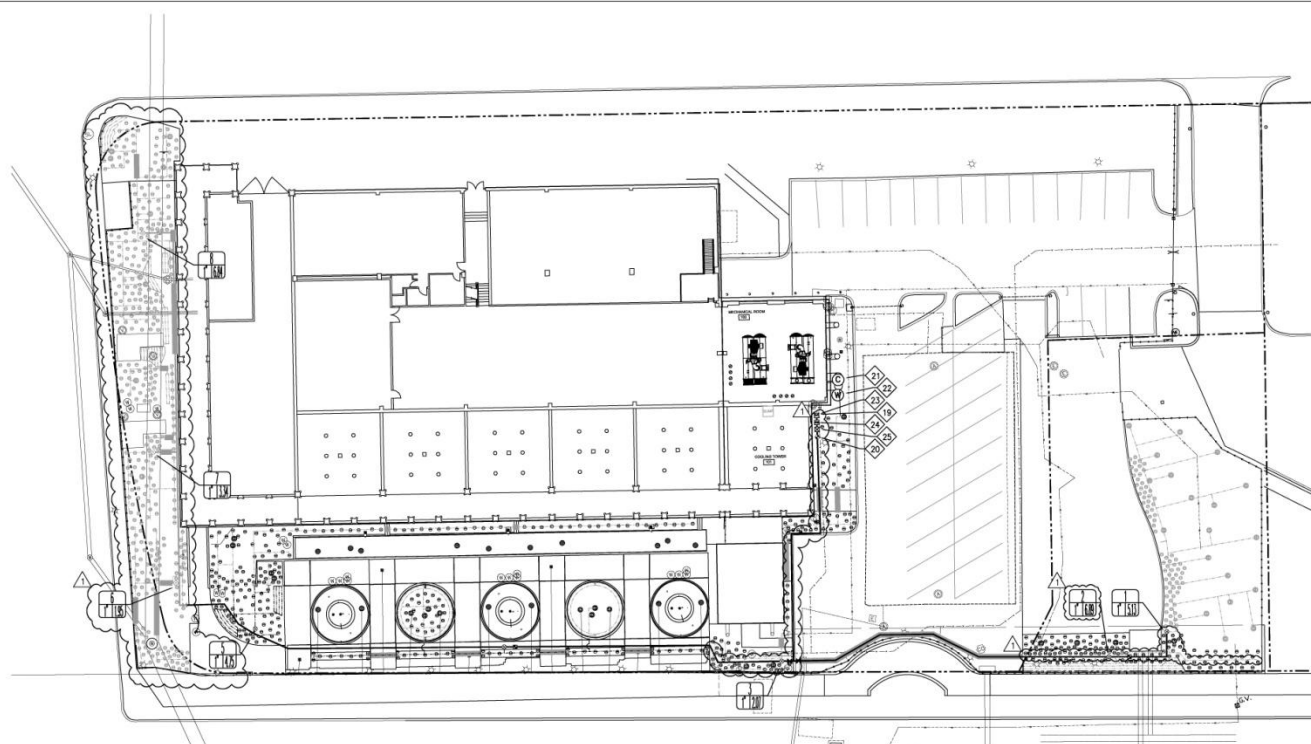

1 OVERALL IRRIGATION PLAN
1'-20'-0"

IRRIGATION DESIGN REQUIREMENTS:

PRESSURE:
 Static PSI: 10 PSI
 Design PSI: 42.22 PSI

PRESSURE LOSS CALCULATIONS:

SPM/ZONE:	6.84	2
Service:	3.71	
Water:	3.9	
Backflow Preventer:	1.20	
Master Control Valve:	1.02	
Elevation Loss:	4.85	
Manning:	1.12	
Remote Control Valve:	1.7	
Head PSI:	20	
TOTAL LOSSES:	31.22	

CONFORMITY LETTER:

I, Leticia Zavala, a licensed irrigator in the State of Texas do hereby certify that the irrigation plan submitted conforms to the irrigation design and equipment standards set out in 95-510(j) and 95-510(k)(6) of the City of San Antonio Unified Development Code and also complies with the requirements of Chapter 344, 344.12 - 344.11 of the Texas Administrative Code.

By: *Leticia Zavala*
 Licensed Irrigator's Number: #6650

VALVE SCHEDULE

STATION NO.	SIZE	GPM	*PRECIP RATE	**SCHEDULE MIN per DAY/WK
1	1"	5.13	2.8	T2 min/3 days
2	1"	6.31	2.8	T2 min/3 days
3	1"	2.87	2.8	T2 min/3 days
4	1"	5.93	2.8	T2 min/3 days
5	1"	4.75	2.8	T2 min/3 days
6	1"	1.98	2.8	T2 min/3 days
7	1"	3.34	2.8	T2 min/3 days
8	1"	6.84	2.8	T2 min/3 days

*REQUIRED PRECIPITATION RATE = 275"/HOUR
 **WATER SCHEDULE REQUIRED TO PROVIDE 1"/WEEK



1410 John Health Dr., Suite 208
 San Antonio, Texas 78229
 210-366-1911/210-366-9844 fax

1	ADDENDUM 2	SSJ	ABF	2/29/15
No.	Revision	Drawn	Approved	Date

REVISIONS:

CHILLED WATER PLANT IMPROVEMENTS PHASE II - ADDENDUM #2 IRRIGATION PLAN

DEVELOPER:	BUDGET PROJ.
CONT.:	
SUBMITTED:	
APPROVED:	
MAP No.:	
SECT. No.:	



DR SSJ CX ABF JOB No. 15-058 SHEET L10 OF 14

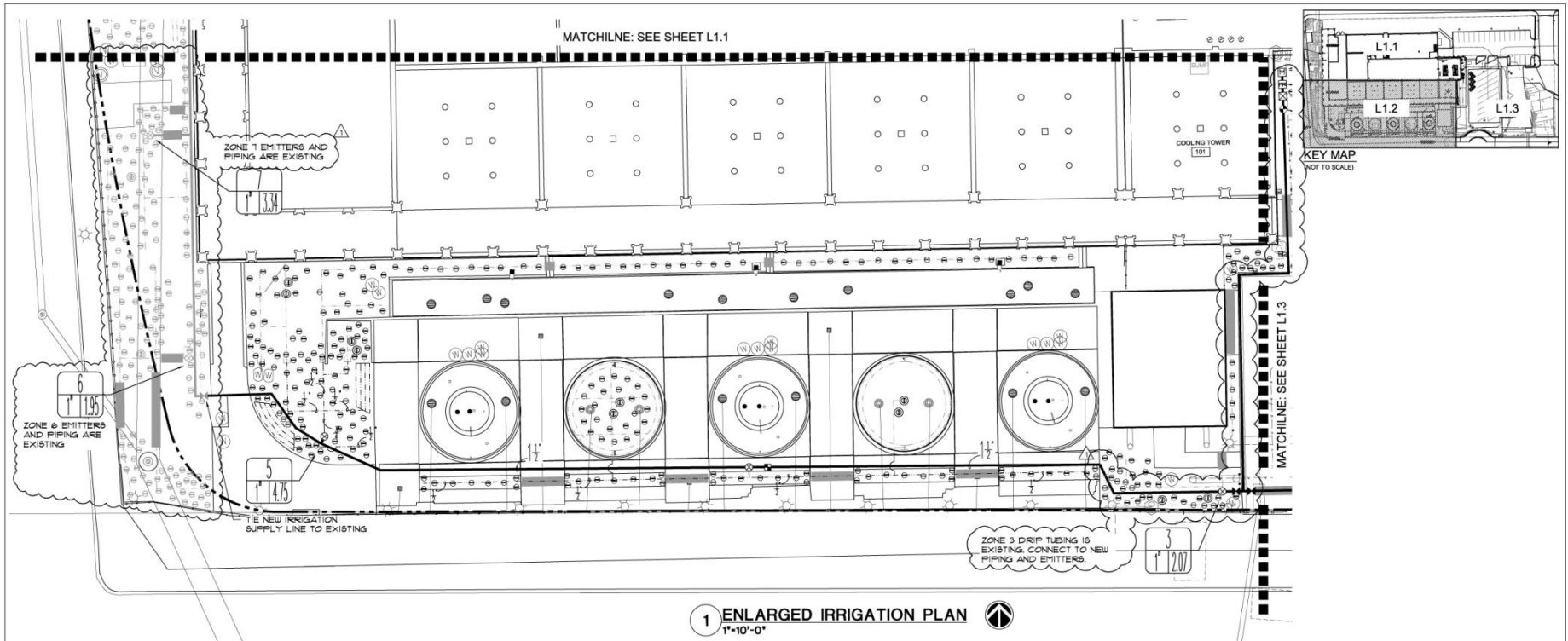

LEGEND

- ⊙ TREE DRIP BUBBLER ASSEMBLY, SEE DTL. 4/L2.2
- ⊙ DRIP EMITTER, SEE DTL. 3/L2.2
- ⊙ DRIP REMOTE CONTROL VALVE, SEE DTL. 2/L2.2
- ⊙ MASTER CONTROL VALVE, SEE DTL. 2/L2.1
- ⊙ MANUAL VALVE, SEE DTL. 1/L2.1
- ⊙ QUICK COUPLER, SEE DTL. 3/L2.1
- ⊙ LATERAL PIPING, SEE DTL. 4/L2.1
- ⊙ DRIP LINE, SEE DTL. 4/L2.1
- ⊙ SUPPLY LINE, SEE DTL. 4/L2.1
- ⊙ IRRIGATION SLEEVE, SEE DTL. 10/L2.2
- ⊙ BED EDGER, SEE SHEET L5.1
- ⊙ VALVE DESIGNATION
- ⊙ GALLONS PER MINUTE
- ⊙ VALVE SIZE
- ⊙ EXISTING TREE DRIP BUBBLER ASSEMBLY
- ⊙ EXISTING DRIP EMITTER
- ⊙ EXISTING DRIP REMOTE CONTROL VALVE
- ⊙ EXISTING MASTER CONTROL VALVE
- ⊙ EXISTING MANUAL VALVE
- ⊙ EXISTING QUICK COUPLER
- ⊙ EXISTING LATERAL PIPING
- ⊙ EXISTING DRIP LINE
- ⊙ EXISTING SUPPLY LINE

IRRIGATION NOTES (⬠ - Keyed Note)

1. Irrigation contractor shall be responsible for making himself familiar with the specifications and all submittal requirements. It is the responsibility of the irrigation contractor to notify the Landscape Architect for site inspections as specified in the specifications. Failure to notify the Landscape Architect does not relieve the contractor from inspection approval and will require the contractor to uncover work as required for approval at the cost of the contractor. Irrigation contractor is to inform Landscape Architect of the start date of work.
2. The irrigation contractor is required by law to notify Texas One Call (800-248-4848) and (800) DIAL TESS (800-344-8311) 72 hours prior to any excavation. Irrigation contractor shall be responsible for making himself familiar with all underground utilities, pipes and structures. Irrigation contractor shall take sole responsibility for any cost incurred due to damage of said utilities whether or not Texas One Call is notified.
3. Do not willfully proceed with construction as designed without verifying actual on-site water pressure from the source. Do not willfully proceed with construction as designed when it is obvious that unknown obstructions and/or grade differences exist that may not have been known during design. Such conditions shall be immediately brought to the attention of the Landscape Architect or Owner's Representative. The irrigation contractor shall assume full responsibility for all necessary revisions due to failure to give such notification.
4. Irrigation contractor shall be responsible for any coordination with other contractors as required to accomplish irrigation installation.
5. Due to scale of drawings, it is not possible to indicate all offsets, fittings, sleeves, etc. which may be required. Irrigation contractor shall carefully investigate the structural and ground conditions affecting all of his work and plan his work accordingly, furnishing such fittings, etc. as may be required to meet such conditions. Drawings are generally diagrammatic and indicative of the work to be installed. The work shall be installed in such a manner as to avoid conflicts between irrigation system, planting and architectural features. This design is diagrammatic. All piping, valves, etc. known within paved areas is for design clarification only and shall be installed in planting areas and within property lines.
6. It is the irrigation contractor's responsibility to coordinate piping with the landscape subcontractor to avoid conflict with planting beds. It will be the responsibility of the irrigation subcontractor to move piping to allow proper placement of plant material.
7. Irrigation contractor shall be responsible for sleeves and chases wherever piping or conduit passes under all paving through walls, etc. All sleeve locations may not be shown on plan. Coordinate with architectural and civil draughting, general contractor and other subcontractors as required. All sleeves and chase locations are not noted on plan. All sleeves shall be 5ch 40 PVC, sized twice the diameter of pipe or combination of pipes enclosed within the sleeve.
8. No cutting, filling, trenching, root disturbance, soil disturbance, or construction impacts shall occur closer to the tree than 1/2 the root protection zone radius. In accordance with City of San Antonio Code 35-523.1(X), unless done by hand, trenching is to be done by hand or by tunneling under root system by method approved by Landscape Architect. Piping layout is diagrammatic and piping shall be routed around existing plant material to avoid damage to existing plants. Do not cut any root over 3/4" diameter. Any cuts made shall be clean and without frayed ends.
9. All work will be in accordance with the requirements of the City of San Antonio Unified Development Code 35-502(J) and 35-511(L)(6) and the Texas Administrative Code Chapter 344, 344.70-344.71.
10. If actual site static pressure exceeds design pressure by 10%, a pressure reducing valve shall be installed. See specifications.
11. Pressure at any point within a zone shall not vary by more than 10% from the design sprinkler operating pressure. See specifications for testing.
12. All irrigation work shall be installed under the supervision of a licensed (in the state of Texas) irrigation contractor.
13. Obtain coverage test approval from Landscape Architect or Owner's Representative prior to planting, sodding or seeding.
14. All undesignated end lateral piping shall be 1/2".
15. Irrigation Contractor is to provide 15-emitters and associated fittings and piping for use on Irrigation zone(s) as directed in the field by Landscape Architect.
16. Refer to civil plans for grading plan.
17. Statement of Area Coverage: Drawing does not provide for 100% coverage of the site. See plans and specifications for areas to be irrigated.
18. Irrigation system is a reuse water system. Install purple pipe, heads, valve box covers and signage per specifications.
19. New 1" irrigation submeter to be supplied by existing reuse water line. See dtl. 3/L2.1
20. 1-1/2" Master control valve. See dtl. 7/L2.1
21. Locate controller in Mechanical Room. Contractor is responsible for coordinating with other trades as required to provide power.
22. Locate weather sensors at outside of Mechanical Room.
23. Point of connection
24. Pressure reducing valve, see dtl. 10/L2.1
25. Reduced pressure backflow preventer, see dtl. 1/L2.1
26. Contractor is responsible for providing all components necessary to ensure the irrigation system functions properly. This includes, but is not limited to, supply line, sleeves, valves, quick couplers, lateral, drip tubing and emitters in existing planting areas.
27. Contractor shall verify with Landscape Architect location of supply line in parking lot prior to trenching or installation.

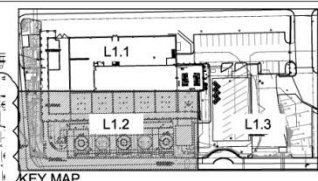

C+P-Z Group LLC
Landscape Architecture & Planning
1410 John Webb Dr., Suite 200
San Antonio, Texas 78220
210-366-1911/210-366-0904 fax

REVISIONS			
No.	Revision	Drawn	Approved
1	ADDENDUM 2	SOT	ARF/JR 2/29/15

CHILLED WATER PLANT IMPROVEMENTS PHASE II - ADDENDUM #2 IRRIGATION PLAN

DEVELOPER:	CONTRACTOR:
SUBMITTED:	APPROVED:
MAP No.:	SECT. No.:
DATE:	DR. SOT CK. ARF JOB No. 15-958
SHEET	OF 14

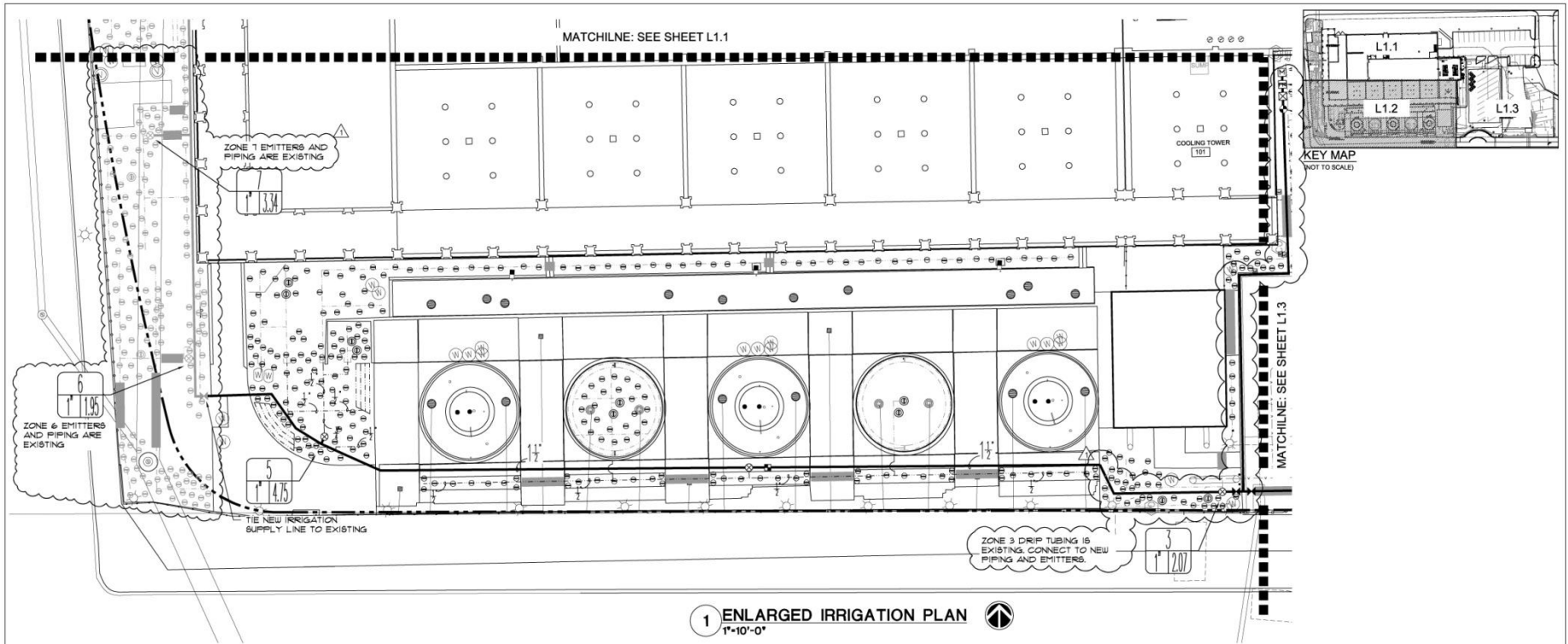

LEGEND

- ⊙ TREE DRIP BUBBLER ASSEMBLY, SEE DTL. 4/L2.2
- ⊙ DRIP EMITTER, SEE DTL. 3/L2.2
- ⊙ DRIP REMOTE CONTROL VALVE, SEE DTL. 2/L2.2
- ⊙ MASTER CONTROL VALVE, SEE DTL. 2/L2.1
- ⊙ MANUAL VALVE, SEE DTL. 1/L2.1
- ⊙ QUICK COUPLER, SEE DTL. 3/L2.1
- ⊙ LATERAL PIPING, SEE DTL. 4/L2.1
- ⊙ DRIP LINE, SEE DTL. 4/L2.1
- ⊙ SUPPLY LINE, SEE DTL. 4/L2.1
- ⊙ IRRIGATION SLEEVE, SEE DTL. 10/L2.2
- ⊙ BED EDGER, SEE SHEET L5.1
- ⊙ VALVE DESIGNATION
- ⊙ GALLONS PER MINUTE
- ⊙ VALVE SIZE
- ⊙ EXISTING TREE DRIP BUBBLER ASSEMBLY
- ⊙ EXISTING DRIP EMITTER
- ⊙ EXISTING DRIP REMOTE CONTROL VALVE
- ⊙ EXISTING MASTER CONTROL VALVE
- ⊙ EXISTING MANUAL VALVE
- ⊙ EXISTING QUICK COUPLER
- ⊙ EXISTING LATERAL PIPING
- ⊙ EXISTING DRIP LINE
- ⊙ EXISTING SUPPLY LINE

IRRIGATION NOTES (⬠ - Keyed Note)

1. Irrigation contractor shall be responsible for making himself familiar with the specifications and all submittal requirements. It is the responsibility of the irrigation contractor to notify the Landscape Architect for site inspections as specified in the specifications. Failure to notify the Landscape Architect does not relieve the contractor from inspection approval and will require the contractor to uncover work as required for approval at the cost of the contractor. Irrigation contractor is to inform Landscape Architect of the start date of work.
2. The irrigation contractor is required by law to notify Texas One Call (800-248-4848) and (800) DIAL TESS (800-344-8311) 72 hours prior to any excavation. Irrigation contractor shall be responsible for making himself familiar with all underground utilities, pipes and structures. Irrigation contractor shall take sole responsibility for any cost incurred due to damage of said utilities whether or not Texas One Call is notified.
3. Do not willfully proceed with construction as designed without verifying actual on-site water pressure from the source. Do not willfully proceed with construction as designed when it is obvious that unknown obstructions and/or grade differences exist that may not have been known during design. Such conditions shall be immediately brought to the attention of the Landscape Architect or Owner's Representative. The irrigation contractor shall assume full responsibility for all necessary revisions due to failure to give such notification.
4. Irrigation contractor shall be responsible for any coordination with other contractors as required to accomplish irrigation installation.
5. Due to scale of drawings, it is not possible to indicate all offsets, fittings, sleeves, etc. which may be required. Irrigation contractor shall carefully investigate the structural and ground conditions affecting all of his work and plan his work accordingly, furnishing such fittings, etc. as may be required to meet such conditions. Drawings are generally diagrammatic and indicative of the work to be installed. The work shall be installed in such a manner as to avoid conflicts between irrigation system, planting and architectural features. This design is diagrammatic. All piping, valves, etc. known within paved areas is for design clarification only and shall be installed in planting areas and within property lines.

6. It is the irrigation contractor's responsibility to coordinate piping with the landscape subcontractor to avoid conflict with planting beds. It will be the responsibility of the irrigation subcontractor to move piping to allow proper placement of plant material.
7. Irrigation contractor shall be responsible for sleeves and chases wherever piping or conduit passes under all paving through walls, etc. All sleeve locations may not be shown on plan. Coordinate with architectural and civil draughting, general contractor and other subcontractors as required. All sleeves and chase locations are not noted on plan. All sleeves shall be 5ch 40 PVC, sized twice the diameter of pipe or combination of pipes enclosed within the sleeve.
8. No cutting, filling, trenching, root disturbance, soil disturbance or construction impacts shall occur closer to the tree than 1/2 the root protection zone radius. In accordance with City of San Antonio Code 35-523.1(X), unless done by hand, trenching is to be done by hand or by tunneling under root system by method approved by Landscape Architect. Piping layout is diagrammatic and piping shall be routed around existing plant material to avoid damage to existing plants. Do not cut any root over 3/4" diameter. Any cuts made shall be clean and without frayed ends.
9. All work will be in accordance with the requirements of the City of San Antonio Unified Development Code 35-523.1 and 35-511.2(x) and the Texas Administrative Code Chapter 344, 344.70-344.71.
10. If actual site static pressure exceeds design pressure by 10%, a pressure reducing valve shall be installed. See specifications.
11. Pressure at any point within a zone shall not vary by more than 10% from the design sprinkler operating pressure. See specifications for testing.
12. All irrigation work shall be installed under the supervision of a licensed (in the state of Texas) irrigation contractor.
13. Obtain coverage test approval from Landscape Architect or Owner's Representative prior to planting, sodding or seeding.
14. All undesignated end lateral piping shall be 1/2".

15. Irrigation Contractor is to provide 15-emitters and associated fittings and piping for use on Irrigation zone(s) as directed in the field by Landscape Architect.
16. Refer to civil plans for grading plan.
17. Statement of Area Coverage: Drawing does not provide for 100% coverage of the site. See plans and specifications for areas to be irrigated.
18. Irrigation system is a reuse water system. Install purple pipe, heads, valve box covers and signage per specifications.
19. New 1" irrigation submeter to be supplied by existing reuse water line. See dtl. 3/L2.1
20. 1-1/2" Master control valve. See dtl. 7/L2.1
21. Locate controller in Mechanical Room. Contractor is responsible for coordinating with other trades as required to provide power.
22. Locate weather sensors at outside of Mechanical Room.
23. Point of connection
24. Pressure reducing valve, see dtl. 10/L2.1
25. Reduced pressure backflow preventer, see dtl. 1/L2.1
26. Contractor is responsible for providing all components necessary to ensure the irrigation system functions properly. This includes, but is not limited to, supply line, sleeves, valves, quick couplers, lateral, drip tubing and emitters in existing planting areas.
27. Contractor shall verify with Landscape Architect location of supply line in parking lot prior to trenching or installation.

C+P-Z Group LLC
 LANDSCAPE ARCHITECTURE, PLANNING & DESIGN
 7410 John Road, Dr. Suite 200
 San Antonio, Texas 78220
 210-366-1911/210-366-0994 fax

CHILLED WATER PLANT IMPROVEMENTS PHASE II - ADDENDUM #2 IRRIGATION PLAN

REVISIONS			
No.	Revision	Drawn	Approved
1	ADDENDUM 2	SOT	ARF/JR
2			
3			
4			
5			

DEVELOPER: []
 CONT.: BUDGET PROJ.
 SUBMITTED: []
 APPROVED: []
 MAP No.: 8555
 SECT. No.: 15-958
 DATE: 01/27/2006

DR. SOT | CK. ARF | JOB No. 15-958 | SHEET L12 OF 14

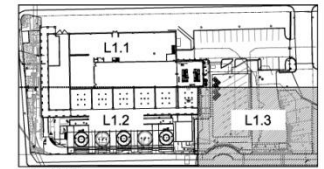

KEY MAP
(NOT TO SCALE)

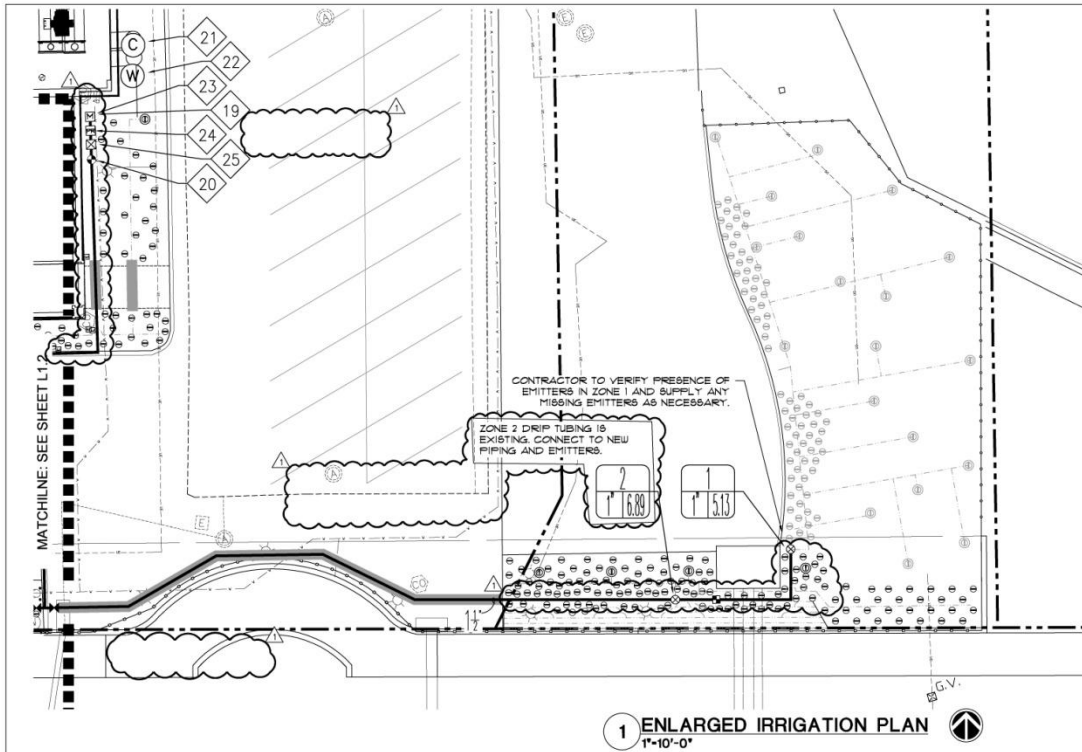

1 ENLARGED IRRIGATION PLAN
1"=10'-0"

LEGEND

- ⊙ TREE DRIP BUBBLER ASSEMBLY, SEE DTL. 4/L2.2
- ⊙ DRIP EMITTER, SEE DTL. 3/L2.2
- ⊙ DRIP REMOTE CONTROL VALVE, SEE DTL. 2/L2.2
- ⊙ MASTER CONTROL VALVE, SEE DTL. 2/L2.1
- ⊙ MANUAL VALVE, SEE DTL. 1/L2.1
- ⊙ QUICK COUPLER, SEE DTL. 3/L2.1
- ⊙ LATERAL PIPING, SEE DTL. 4/L2.1
- ⊙ DRIP LINE, SEE DTL. 4/L2.1
- ⊙ SUPPLY LINE, SEE DTL. 4/L2.1
- ⊙ IRRIGATION SLEEVE, SEE DTL. 10/L2.2
- ⊙ BED EDGER, SEE SHEET L5.1
- ⊙ VALVE DESIGNATION
- ⊙ GALLONS PER MINUTE
- ⊙ VALVE SIZE
- ⊙ EXISTING TREE DRIP BUBBLER ASSEMBLY
- ⊙ EXISTING DRIP EMITTER
- ⊙ EXISTING DRIP REMOTE CONTROL VALVE
- ⊙ EXISTING MASTER CONTROL VALVE
- ⊙ EXISTING MANUAL VALVE
- ⊙ EXISTING QUICK COUPLER
- ⊙ EXISTING LATERAL PIPING
- ⊙ EXISTING DRIP LINE
- ⊙ EXISTING SUPPLY LINE

IRRIGATION NOTES (Keyed Note)

1. Irrigation contractor shall be responsible for making himself familiar with the specifications and all submittal requirements. It is the responsibility of the irrigation contractor to notify the Landscape Architect for site inspections as specified in the specifications. Failure to notify the Landscape Architect does not relieve the contractor from inspection approval and will require the contractor to uncover work as required for approval at the cost of the contractor. Irrigation contractor is to inform Landscape Architect of the start date of work.
2. The irrigation contractor is required by law to notify Texas One Call (800-248-4848) and (800) DIAL TESS (800-344-8311) 72 hours prior to any excavation. Irrigation contractor shall be responsible for making himself familiar with all underground utilities, pipes and structures. Irrigation contractor shall take sole responsibility for any cost incurred due to damage of said utilities whether or not Texas One Call is notified.
3. Do not willfully proceed with construction as designed without verifying actual on-site water pressure from the source. Do not willfully proceed with construction as designed when it is obvious that unknown obstructions and/or grade differences exist that may not have been known during design. Such conditions shall be immediately brought to the attention of the Landscape Architect or Owner's Representative. The irrigation contractor shall assume full responsibility for all necessary revisions due to failure to give such notification.
4. Irrigation contractor shall be responsible for any coordination with other contractors as required to accomplish irrigation installation.
5. Due to scale of drawings, it is not possible to indicate all offsets, fittings, sleeves, etc. which may be required. Irrigation contractor shall carefully investigate the structural and finished conditions affecting all of his work and plan his work accordingly, furnishing such fittings, etc. as may be required to meet such conditions. Drawings are generally diagrammatic and indicative of the work to be installed. The work shall be installed in such a manner as to avoid conflicts between irrigation system, planting and architectural features. This design is diagrammatic. All piping, valves, etc. known within planted areas is for design clarification only and shall be installed in planting areas and within property lines.
6. It is the irrigation contractor's responsibility to coordinate piping with the landscape subcontractor to avoid conflict with planting beds. It will be the responsibility of the irrigation subcontractor to move piping to allow proper placement of plant material.
7. Irrigation contractor shall be responsible for sleeves and chases wherever piping or conduit passes under all paving through walls, etc. All sleeve locations may not be shown on plan. Coordinate with architectural and civil drawings, general contractor and other subcontractors as required. All sleeves and chase locations are not noted on plan. All sleeves shall be 5ch 40 PVC, sized twice the diameter of pipe or combination of pipes enclosed within the sleeve.
8. No cutting, filling, trenching, root disturbance, soil disturbance, or construction impacts shall occur closer to the trees than 1/2 the root protection zone radius. In accordance with City of San Antonio Code 35-523.1(X), unless done by hand, trenching is to be done by hand or by tunneling under root system by method approved by Landscape Architect. Piping layout is diagrammatic and piping shall be routed around existing plant material to avoid damage to existing plants. Do not cut any root over 3/4" diameter. Any cuts made shall be clean and without frayed ends.
9. All work will be in accordance with the requirements of the City of San Antonio Unified Development Code 35-523(J) and 35-511(L)(6) and the Texas Administrative Code Chapter 344, 344.70-344.71.
10. If actual site static pressure exceeds design pressure by 10%, a pressure reducing valve shall be installed. See specifications for testing.
11. Pressure at any point within a zone shall not vary by more than 10% from the design sprinkler operating pressure. See specifications for testing.
12. All irrigation work shall be installed under the supervision of a licensed (in the State of Texas) irrigation contractor.
13. Obtain coverage test approval from Landscape Architect or Owner's Representative prior to planting, sodding or seeding.
14. All undesignated end lateral piping shall be 1/2".
15. Irrigation Contractor is to provide 15-emitters and associated fittings and piping for use on irrigation zone(s) as directed in the field by Landscape Architect.
16. Refer to civil plans for grading plan.
17. Statement of Area Coverage: Drawing does not provide for 100% coverage of the site. See plans and specifications for areas to be irrigated.
18. Irrigation system is a reuse water system. Install purple pipe, heads, valve box covers and signage per specifications.
19. New 1" irrigation submeter to be supplied by existing reuse water line. See dtl. 3/L2.1
20. 1-1/2" Master control valve. See dtl. 7/L2.1
21. Locate controller in Mechanical Room. Contractor is responsible for coordinating with other trades as required to provide power.
22. Locate weather sensors at outside of Mechanical Room.
23. Point of connection
24. Pressure reducing valve, see dtl. 10/L2.1
25. Reduced pressure backflow preventer, see dtl. 1/L2.1
26. Contractor is responsible for providing all components necessary to ensure the irrigation system functions properly. This includes, but is not limited to supply line, sleeves, valves, quick couplers, laterals, drip tubing and emitters in existing planting areas.
27. Contractor shall verify with Landscape Architect location of supply line in parking lot prior to trenching or installation.



C+P-Z Group LLC
COURTNEY FERRARIS, P.E.
Landscape Architect
& Planning
7410 John Road, Dr. Suite 200
San Antonio, Texas 78220
210-366-1911/210-366-2094 fax

REVISIONS			
No.	Revision	Drawn	Approved
1	ADDENDUM 2	SOT	ARF/JR
2			
3			

DEVELOPER: CHILLED WATER PLANT IMPROVEMENTS PHASE II - ADDENDUM #2 IRRIGATION PLAN

CONTRACTOR:	BUDGET PROJ.
SUBMITTED:	
APPROVED:	
MAP No.:	
SECT. No.:	
DATE:	02/27/2008
DR. SOT	CK. ARF
JOB No. 15-958	
SHEET	113
OF	14

DEMOLITION/CONSTRUCTION NOTES (KEYED NOTES)

- Contractor shall be responsible for making himself familiar with the specifications and all submittal requirements. It is the responsibility of the contractor to notify the Landscape Architect for site inspections as specified in the specifications. Failure to notify the Landscape Architect does not relieve the contractor from inspection approval and will require the contractor to install work as required for approval by Landscape Architect and at the cost of the contractor.
- The contractor is required by law to notify Texas One Call (800-745-4545) 17 hours prior to any excavation. Contractor shall be responsible for making himself familiar with all underground utilities, pipes and structures. Contractor shall take sole responsibility for any cost incurred due to damage of said utilities whether or not Texas One Call is notified.
- Do not willfully proceed with construction as designed when it is obvious that unknown obstructions and/or grade differences exist that may not have been known during design. Such conditions shall be immediately brought to the attention of the Landscape Architect or Owner's Representative. The contractor shall assume full responsibility for all necessary revisions due to failure to give such notification.
- Contractor shall be responsible for any coordination with other contractors as required to accomplish all construction operations. All piping, conduit, sleeves, etc. shall be set in place prior to installation of construction items.
- Refer to State/City Standard Plans and specifications where applicable.
- All existing improvements, materials, utilities and plant material to remain within the new construction area shall be properly and adequately protected from damage during demolition operations. It shall be the responsibility of the Contractor to restore to the original condition any of these existing items that are damaged or disturbed in any way within or near construction area and to be protected for duration of construction.

- Streets and adjacent property shall be protected throughout the work as required by local bodies and regulations and approved by the Owner.
- During demolition operations, every effort shall be made to control dust per City requirements.
- The entire demolition area shall be grubbed. Grubbing shall include all stumps and root systems of removed plant material and any other deleterious items. Grubbing shall be to the depth as required to remove these items.
- All forms must be inspected and approved by the Landscape Architect prior to the installation of any construction.
- Install felt expansion joints, sealant and backer rod where paving abuts existing hardscape.
- All new paving shall match existing grade.
 - 13 EXISTING CONCRETE PAVING, ALT. PAV. STAINED CONCRETE PAVING
 - 14 NEW CONCRETE PAVING TO MATCH EXISTING, SEE DTL. 1/LS.3
 - 15 ALT. PAV. STAINED CONCRETE PAVING
 - 16 EXISTING CLAY PAVERS
 - 17 ALT. FINI. STAINED CONCRETE PAVERS
 - 18 NEW CLAY PAVERS TO MATCH EXISTING, SEE DTL. 2/LS.3
 - 19 ALT. FINI. STAINED CONCRETE PAVERS TO MATCH EXISTING
 - 20 ALT. PI. CHIP SEAL ASPHALT PARKING LOT, SEE SPECIFICATIONS
 - 21 REFURBISHED EXISTING FOUNTAIN, SEE DTL. 0/LS.3
 - 22 REFURBISHED EXISTING REFLECTING POOL, SEE DTL. 4/LS.3

- 23 NEW PLANTER, SEE DTL. 6/LS.3
- 24 DECOMPOSED GRANITE, SEE DTL. 4/LS.1
- 25 STEEL EDGING, SEE DTL. 2/LS.1
- 26 EXISTING PLANTER, PROTECT IN PLACE
- 27 FENCE, BY OTHERS
- 28 EXISTING FENCE TO REMAIN
- 29 EXISTING BUS STOP TO REMAIN
- 30 EXISTING UTILITY TO REMAIN
- 31 MAINTENANCE VEHICLE ACCESS
- 32 REMOVE EXISTING CONCRETE
- 33 REMOVE EXISTING PAVERS, CONCRETE SUBSLAB AND BASE
- 34 REMOVE EXISTING STEEL EDGING
- 35 REMOVE EXISTING CONCRETE AS NEEDED FOR FOUNTAIN REPAIR, SEE MEP DWG66.
- 36 REMOVE EXISTING CONCRETE PAVERS AS NEEDED FOR FOUNTAIN REPAIR, SEE MEP DWG66.
- 37 REMOVE EXISTING TILE BENCH, REPAIR FOUNTAIN/PLANTER WALL AT BENCH LOCATIONS.

35. Paver pattern shown is for graphic representation only. New paver pattern shall match existing pattern.

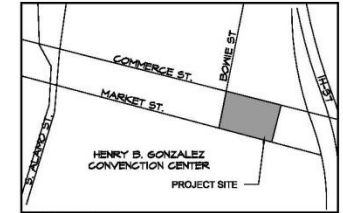

VICINITY MAP
(NOT TO SCALE)

LEGEND

- EXISTING TREE
- EXISTING SHRUB TO REMAIN
- EXISTING SHRUB TO BE REMOVED
- NEW CONCRETE
- NEW PAVERS
- COLORED ASPHALT
- DECOMPOSED GRANITE
- STEEL EDGING
- EXISTING CONCRETE
- EXISTING PAVERS

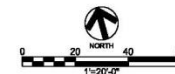
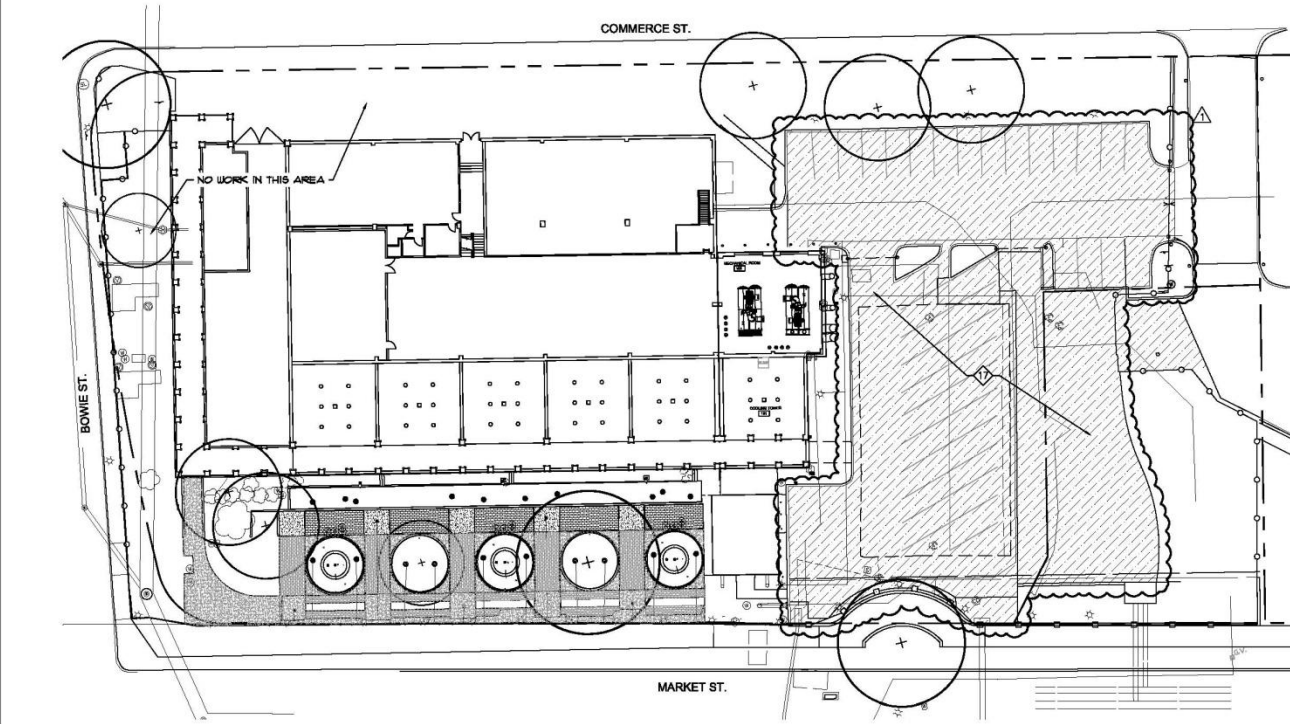

CH2Z Group LLC
 OFFICE: FORT WORTH, TEXAS
 Landscape Architect
 & Planning
 1410 John Redd Dr., Suite 200
 San Antonio, Texas 78225
 210-360-1911/210-360-0994 fax

REVISIONS		DATE
1	ADDENDUM 2	5/09/15
Rev.	Drawn	Approved

CHILLED WATER PLANT IMPROVEMENTS PHASE II - ADDENDUM #2	
SITE PLAN	
DEVELOPER:	BUDGET PROJ.
CONT.	
SUBMITTED	
APPROVED	
MAP No.	SHEET
SECT. No.	LA1
OWNER: DR. SOT. OK. AFB	JOB No. 15-058
	OF 14

DEMOLITION/CONSTRUCTION NOTES (KEYED NOTES)

- Contractor shall be responsible for making himself familiar with the specifications and all substantial requirements. It is the responsibility of the contractor to notify the Landscape Architect for site inspections as specified in the specifications. Failure to notify the Landscape Architect does not relieve the contractor from inspection approval and will require the contractor to install work as required for approval by Landscape Architect and at the cost of the contractor.
- The contractor is required by law to notify Texas One Call (800-745-4545) 17 hours prior to any excavation. Contractor shall be responsible for making himself familiar with all underground utilities, pipes and structures. Contractor shall take sole responsibility for any cost incurred due to damage of said utilities whether or not Texas One Call is notified.
- Do not willfully proceed with construction as designed when it is obvious that unknown obstructions and/or grade differences exist that may not have been known during design. Such conditions shall be immediately brought to the attention of the Landscape Architect or Owner's Representative. The contractor shall assume full responsibility for all necessary revisions due to failure to give such notification.
- Contractor shall be responsible for any coordination with other contractors as required to accomplish all construction operations. All piping, conduit, sleeves, etc. shall be set in place prior to installation of construction items.
- Refer to State/City Standard Plans and specifications where applicable.
- All existing improvements, materials, utilities and plant material to remain within the new construction area shall be properly and adequately protected from damage during demolition operations. It shall be the responsibility of the Contractor to restore to the original condition any of these existing items that are damaged or disturbed in any way. All existing trees within or near construction area are to be protected for duration of construction.

- Streets and adjacent property shall be protected throughout the work as required by local codes and regulations and approved by the Owner.
- During demolition operations, every effort shall be made to control dust per City requirements.
- The entire demolition area shall be grubbed. Grubbing shall include all stumps and root systems of removed plant material and any other deleterious items. Grubbing shall be to the depth as required to remove these items.
- All forms must be inspected and approved by the Landscape Architect prior to the installation of any construction.
- Install felt expansion joints, sealant and backer rod where paving abuts existing hardscape.
- All new paving shall match existing grade.
- EXISTING CONCRETE PAVING, ALT. PAV. STAINED CONCRETE PAVING
- NEW CONCRETE PAVING TO MATCH EXISTING, SEE DTL. 1/LS.3
- ALT. PAV. STAINED CONCRETE PAVING
- EXISTING CLAY PAVERS
- ALT. FINI. STAINED CONCRETE PAVERS
- NEW CLAY PAVERS TO MATCH EXISTING, SEE DTL. 2/LS.3
- ALT. FINI. STAINED CONCRETE PAVERS TO MATCH EXISTING
- ALT. PI. CHIP SEAL ASPHALT PARKING LOT, SEE SPECIFICATIONS
- REFURBISHED EXISTING FOUNTAIN, SEE DTL. 0/LS.3
- REFURBISHED EXISTING REFLECTING POOL, SEE DTL. 4/LS.3

- NEW PLANTER, SEE DTL. 6/LS.3
- DECOMPOSED GRANITE, SEE DTL. 4/LS.1
- STEEL EDGING, SEE DTL. 1/LS.1
- EXISTING PLANTER, PROTECT IN PLACE
- FENCE, BY OTHERS
- EXISTING FENCE TO REMAIN
- EXISTING BUS STOP TO REMAIN
- EXISTING UTILITY TO REMAIN
- MAINTENANCE VEHICLE ACCESS
- REMOVE EXISTING CONCRETE
- REMOVE EXISTING PAVERS, CONCRETE SUBSLAB AND BASE
- REMOVE EXISTING STEEL EDGING
- REMOVE EXISTING CONCRETE AS NEEDED FOR FOUNTAIN REPAIR, SEE MEP DWG5.
- REMOVE EXISTING CONCRETE PAVERS AS NEEDED FOR FOUNTAIN REPAIR, SEE MEP DWG5.
- REMOVE EXISTING TILE BENCH, REPAIR FOUNTAIN/PLANTER WALL AT BENCH LOCATIONS.

35. Paver pattern shown is for graphic representation only. New paver pattern shall match existing pattern.

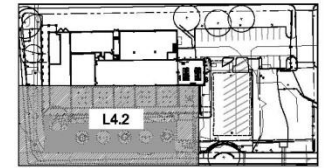

KEY MAP (NOT TO SCALE)

LEGEND

- EXISTING TREE
- EXISTING SHRUB TO BE REMOVED
- NEW CONCRETE
- NEW PAVERS
- COLORED ASPHALT
- DECOMPOSED GRANITE
- EXISTING CONCRETE
- EXISTING PAVERS

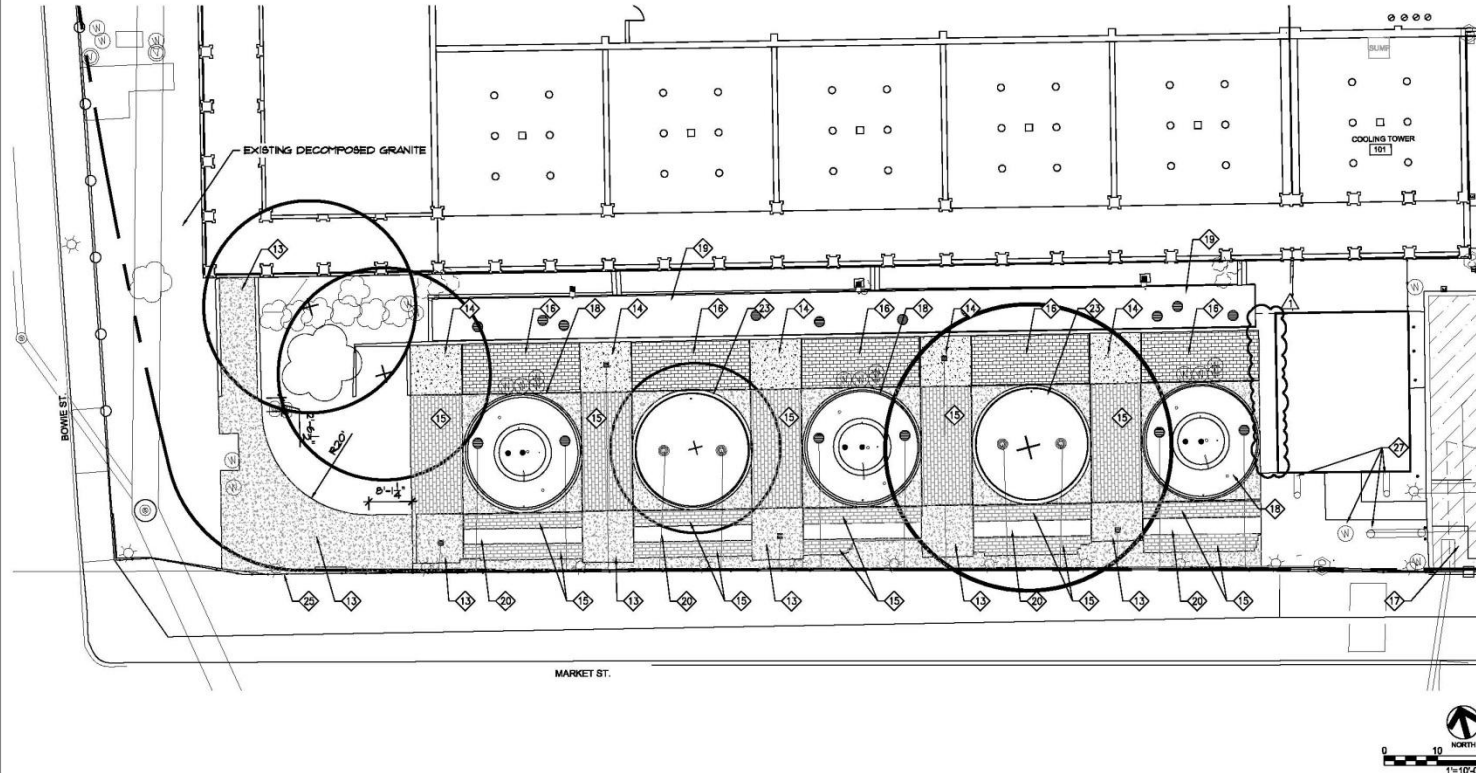

CH2Z Group LLC
 DESIGN & PLANNING
 Landscape Architecture
 & Planning
 1410 John Webb Dr., Suite 200
 San Antonio, Texas 78225
 210-350-1911/210-350-0944

Rev.	Revision	By	Date
1	ADDENDUM 2	SDT	5/20/15

SEVISIONS

CHILLED WATER PLANT IMPROVEMENTS PHASE I - ADDENDUM #2

SITE PLAN

DEVELOPER: _____
 CONT. BUDGET PROJ. _____
 SUBMITTED _____
 APPROVED _____
 MAP No. _____
 SECT. No. _____

DATE: 05/20/15
 JOB No. 15-058
 SHEET L4.2 OF 14

Chilled Water Plant Improvements Project
 SAWS Job No. 15-7502
 Solicitation No. CO-00051
 January 2016

BID PROPOSAL

PROPOSAL OF _____ a corporation
 a partnership consisting of _____
 an individual doing business as _____

TO THE SAN ANTONIO WATER SYSTEM:

Pursuant to Instructions and Invitation to Bidders, the undersigned proposes to furnish all labor, materials, equipment and supervision as specified and perform the work required for the construction of the **Chilled Water Plant Improvements Project**, San Antonio Water System Job Number 15-7502, in accordance with the Plans and Specifications for the following prices to with:

1. BASE BID WORK

ITEM NO	ITEM DESCRIPTION (PRICE TO BE WRITTEN IN WORDS)	UNIT	QTY	UNIT PRICE (FIGURES)	TOTAL (FIGURES)
1A	Civil and Demolition and Improvements, Complete in Place; _____ Dollars and _____ Cents	LS	1	XXXXXXXX	\$ _____
1B	Plumbing and Demolition and Improvements, Complete in Place; _____ Dollars and _____ Cents	LS	1	XXXXXXXX	\$ _____
1C	Electrical and Demolition and Improvements, Complete in Place; _____ Dollars and _____ Cents	LS	1	XXXXXXXX	\$ _____
SUBTOTAL BASE BID WORK: _____ Dollars and _____ Cents					

2. ADD ALTERNATES:

ITEM NO	ITEM DESCRIPTION (PRICE TO BE WRITTEN IN WORDS)	UNIT	QTY	UNIT PRICE	TOTAL (FIGURES)
ALT P-1	22,210 sf Asphalt chip seal; _____ Dollars and _____ Cents	LS	1	(RES \$XXX	\$ _____
1ALT	Arcade Lighting, Complete in Place; _____ Dollars and _____ Cents	LS	1	\$XXX	\$ _____
2ALT	Column Lighting at Courtyard (Market Street), Complete in Place; _____ Dollars and _____ Cents	LS	1	\$XXX	\$ _____
3ALT	Column Lighting at Bowie Street, Complete in Place; _____ Dollars and _____ Cents	LS	1	\$XXX	\$ _____
ALT FW1	Stain Existing Concrete Pavers, Complete in Place; _____ Dollars and _____ Cents	LS	1	\$XXX	\$ _____
ALT FW2	Stain Existing Concrete, Complete in Place; _____ Dollars and _____ Cents	LS	1	\$XXX	\$ _____
SUBTOTAL ADD ALTERNATES: _____ Dollars and _____ Cents					

- 1. SUBTOTAL BASE BID WORK ITEMS: \$ _____
- 2. SUBTOTAL ADD ALTERNATES ITEMS: \$ _____
- 3. **TOTAL BID AMOUNT:** \$ _____

_____ Dollars and
_____ Cents

BIDDER'S SIGNATURE & TITLE

FIRM'S PHONE NO. /FAX NO.

FIRM'S NAME (TYPE OR PRINT)

FIRM'S EMAIL ADDRESS

FIRM'S ADDRESS

The Contractor herein acknowledges receipt of the following Addendum Numbers.

ACKNOWLEDGEMENT OF ADDENDUM(s):

ADDENDUM No. _____

DATE:

ADDENDUM No. _____

DATE:

ADDENDUM No. _____

DATE:

ADDENDUM No. _____

DATE:

Owner Reserves the right to accept the overall most responsible Bid Proposal.

1. Bidder acknowledges that estimated quantities are not guaranteed, and are solely for the purpose of comparison of bids. Final payment for all Unit Price Line Items will be based on actual quantities provided, determined as provided in the Contract Documents.

Note: Complete the additional requirements of the proposal which are included on the following pages.

2. Any and all Addenda which are issued by the San Antonio Water System with appropriate signatures which acknowledge receipt shall be attached to and made a part of this Bid Proposal.
3. The Bidder offers to construct the Project in accordance with the Contract Documents for the contract price and to complete the project within **120 calendar days** after the start date, as set forth in the Authorization to Proceed. The Bidder understands and accepts the provisions of the Contract Documents relating to liquidated damages of the Project if not completed on time.
4. The Undersigned agrees to commence work on a date to be specified in a written "Authorization to Proceed", and to substantially complete the work in **110 calendar days** and complete all the work in **120 calendar days** from that date.

Complete the additional requirements of the Proposal which are included on the following pages.



Albert B. Fernandez, Fr.
CFZ Group

ACKNOWLEDGEMENT BY RESPONDENT

Each Respondent shall acknowledge receipt of this Addendum No. 2 by noting such and signing the Bid Proposal.

This undersigned acknowledges receipt of this Addendum No. 2 and the bid proposal submitted herewith is in accordance with the information and stipulations set forth.

Date

Signature of Respondent

END OF ADDENDUM